

SMD Aluminum Electrolytic Capacitors

Features

- 3φ ~ 18φ , 85°C, 2,000 hours assured
- Chip type large capacitance capacitors
- Designed for surface mounting on high density PC board
- RoHS Compliance



Marking color: Black

Specifications

Items	Performance																																																													
Category Temperature Range	-40°C ~ +85°C																																																													
Capacitance Tolerance	±20% (at 120Hz, 20°C)																																																													
Leakage Current (at 20°C)	Rated Voltage	6.3 ~ 100V																																																												
	Time	160 ~ 450V																																																												
	Case size	after 2 minutes																																																												
	Leakage Current	after 5 minutes																																																												
Dissipation Factor (Tanδ at 120Hz, 20°C)	3 ~ 10φ	3 - 10φ																																																												
	12.5 ~ 18φ	12.5 ~ 18φ																																																												
Low Temperature Characteristics (at 120Hz)	Rated Voltage	4.0																																																												
	Z(-25°C)	φ D < 12.5																																																												
	Ratio	φ D ≥ 12.5																																																												
	Z(-40°C)	φ D < 12.5																																																												
Endurance	Test Time	2,000 Hrs																																																												
	Capacitance Change	Within ±20% of initial value (4V: ±30%)																																																												
	Dissipation Factor	Less than 200% of specified value (4V: ±300%)																																																												
	Leakage Current	Within specified value																																																												
Shelf Life Test	* The above Specifications shall be satisfied when the capacitors are restored to 20°C after the rated voltage applied for 2,000 hours at 85°C.																																																													
Ripple Current & Frequency Multipliers	Test time: 1,000 hours; other items are the same as those for the Endurance.																																																													
	The rated voltage shall be applied to the capacitors before the measurements for 160 ~ 450V (Refer to JIS C 5101-4 4.1).																																																													
<table border="1"> <thead> <tr> <th>Rated Voltage</th> <th>4</th> <th>6.3</th> <th>10</th> <th>16</th> <th>25</th> <th>35</th> <th>50</th> <th>63</th> <th>100</th> <th>160 ~ 250</th> <th>400 ~ 450</th> </tr> </thead> <tbody> <tr> <td>3 ~ 10φ</td> <td>0.42</td> <td>0.28</td> <td>0.24</td> <td>0.20</td> <td>0.14</td> <td>0.12</td> <td>0.10</td> <td>0.10</td> <td>0.10</td> <td>-</td> <td>-</td> </tr> <tr> <td>12.5 ~ 18φ</td> <td>-</td> <td>0.38</td> <td>0.34</td> <td>0.30</td> <td>0.26</td> <td>0.22</td> <td>0.18</td> <td>0.14</td> <td>0.10</td> <td>0.20</td> <td>0.25</td> </tr> </tbody> </table> <p>When the capacitance exceeds 1,000μF, 0.02 shall be added every 1,000μF increase.</p>			Rated Voltage	4	6.3	10	16	25	35	50	63	100	160 ~ 250	400 ~ 450	3 ~ 10φ	0.42	0.28	0.24	0.20	0.14	0.12	0.10	0.10	0.10	-	-	12.5 ~ 18φ	-	0.38	0.34	0.30	0.26	0.22	0.18	0.14	0.10	0.20	0.25																								
Rated Voltage	4	6.3	10	16	25	35	50	63	100	160 ~ 250	400 ~ 450																																																			
3 ~ 10φ	0.42	0.28	0.24	0.20	0.14	0.12	0.10	0.10	0.10	-	-																																																			
12.5 ~ 18φ	-	0.38	0.34	0.30	0.26	0.22	0.18	0.14	0.10	0.20	0.25																																																			
<table border="1"> <thead> <tr> <th>Rated Voltage</th> <th>4.0</th> <th>6.3</th> <th>10</th> <th>16</th> <th>25</th> <th>35</th> <th>50</th> <th>63</th> <th>100</th> <th>160 ~ 250</th> <th>400 ~ 450</th> </tr> </thead> <tbody> <tr> <td>Z(-25°C)</td> <td>7</td> <td>4</td> <td>4</td> <td>3</td> <td>2</td> <td>2</td> <td>2</td> <td>2</td> <td>2</td> <td>-</td> <td>-</td> </tr> <tr> <td>Z(-40°C)</td> <td>15</td> <td>8</td> <td>5</td> <td>4</td> <td>3</td> <td>3</td> <td>3</td> <td>3</td> <td>3</td> <td>-</td> <td>-</td> </tr> <tr> <td>Z(+20°C)</td> <td>-</td> <td>5</td> <td>5</td> <td>4</td> <td>2</td> <td>2</td> <td>2</td> <td>2</td> <td>2</td> <td>3</td> <td>6</td> </tr> <tr> <td>Z(+20°C)</td> <td>-</td> <td>14</td> <td>12</td> <td>10</td> <td>5</td> <td>4</td> <td>3</td> <td>3</td> <td>3</td> <td>6</td> <td>10</td> </tr> </tbody> </table> <p>Impedance ratio shall not exceed the values given in the table below.</p>			Rated Voltage	4.0	6.3	10	16	25	35	50	63	100	160 ~ 250	400 ~ 450	Z(-25°C)	7	4	4	3	2	2	2	2	2	-	-	Z(-40°C)	15	8	5	4	3	3	3	3	3	-	-	Z(+20°C)	-	5	5	4	2	2	2	2	2	3	6	Z(+20°C)	-	14	12	10	5	4	3	3	3	6	10
Rated Voltage	4.0	6.3	10	16	25	35	50	63	100	160 ~ 250	400 ~ 450																																																			
Z(-25°C)	7	4	4	3	2	2	2	2	2	-	-																																																			
Z(-40°C)	15	8	5	4	3	3	3	3	3	-	-																																																			
Z(+20°C)	-	5	5	4	2	2	2	2	2	3	6																																																			
Z(+20°C)	-	14	12	10	5	4	3	3	3	6	10																																																			

Diagram of Dimensions

Fig. 1

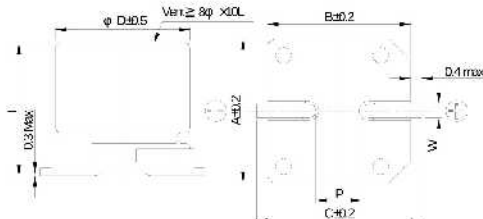
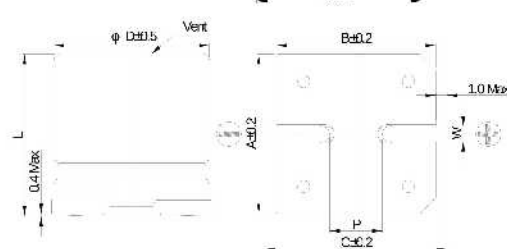

Fig. 2



Lead Spacing and Diameter

Unit: mm

φ D	L	A	B	C	W	P ± 0.2	Fig. No.
3	5.3 ± 0.2	3.3	3.3	4.1	0.45 ~ 0.75	0.8	1
4	5.3 ± 0.2	4.3	4.3	5.1	0.5 ~ 0.8	1.0	1
5	5.3 ± 0.2	5.3	5.3	5.9	0.5 ~ 0.8	1.5	1
6.3	5.3 ± 0.2	6.6	6.6	7.2	0.5 ~ 0.8	2.0	1
6.3	7.7 ± 0.3	6.6	6.6	7.2	0.5 ~ 0.8	2.0	1
8	10 ± 0.5	8.4	8.4	9.0	0.7 ~ 1.1	3.1	1
8	10.3 ± 0.5	8.4	8.4	9.0	0.7 ~ 1.1	3.1	1
10	7.7 ± 0.3	10.4	10.4	11.0	0.7 ~ 1.3	4.7	1
10	10 ± 0.5	10.4	10.4	11.0	0.7 ~ 1.3	4.7	1
10	10.3 ± 0.5	10.4	10.4	11.0	0.7 ~ 1.3	4.7	1
12.5	13.5 ± 0.5	13.0	13.0	13.7	1.1 ~ 1.4	4.4	2
12.5	16 ± 0.5	13.0	13.0	13.7	1.1 ~ 1.4	4.4	2
16	16.5 ± 0.5	17.0	17.0	18.0	1.1 ~ 1.4	6.4	2
16	21.5 ± 0.5	17.0	17.0	18.0	1.1 ~ 1.4	6.4	2
18	16.5 ± 0.5	19.0	19.0	20.0	1.1 ~ 1.4	6.4	2
18	21.5 ± 0.5	19.0	19.0	20.0	1.1 ~ 1.4	6.4	2

